

ISO A1 594mm x 841mm
 Approved: EOM
 Checked: MC
 Designer: CL
 Project Management Initials:
 File name: I:\EU\AECOM\NET\COM\MEMIA\UK\IEDBL2\JOBS\PR-447455_BLESSINGTON_GREENWAY\1900_CAD_GIS\910_CAD\20-SHEETS\LACKAN\60617025_SHT_BLGWY_146_LACKAN_PC_PLAN AND PROFILE.DWG
 Last saved by: PATRICK CRAIG Last Plotter: 2023-12-15

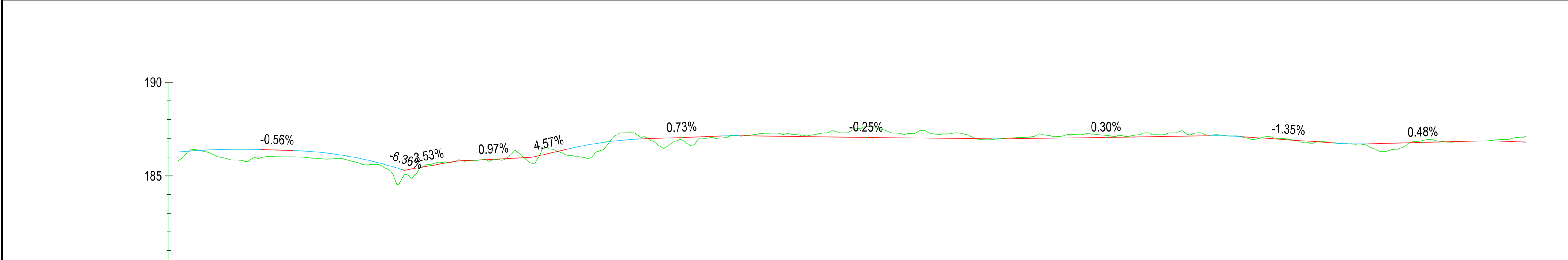
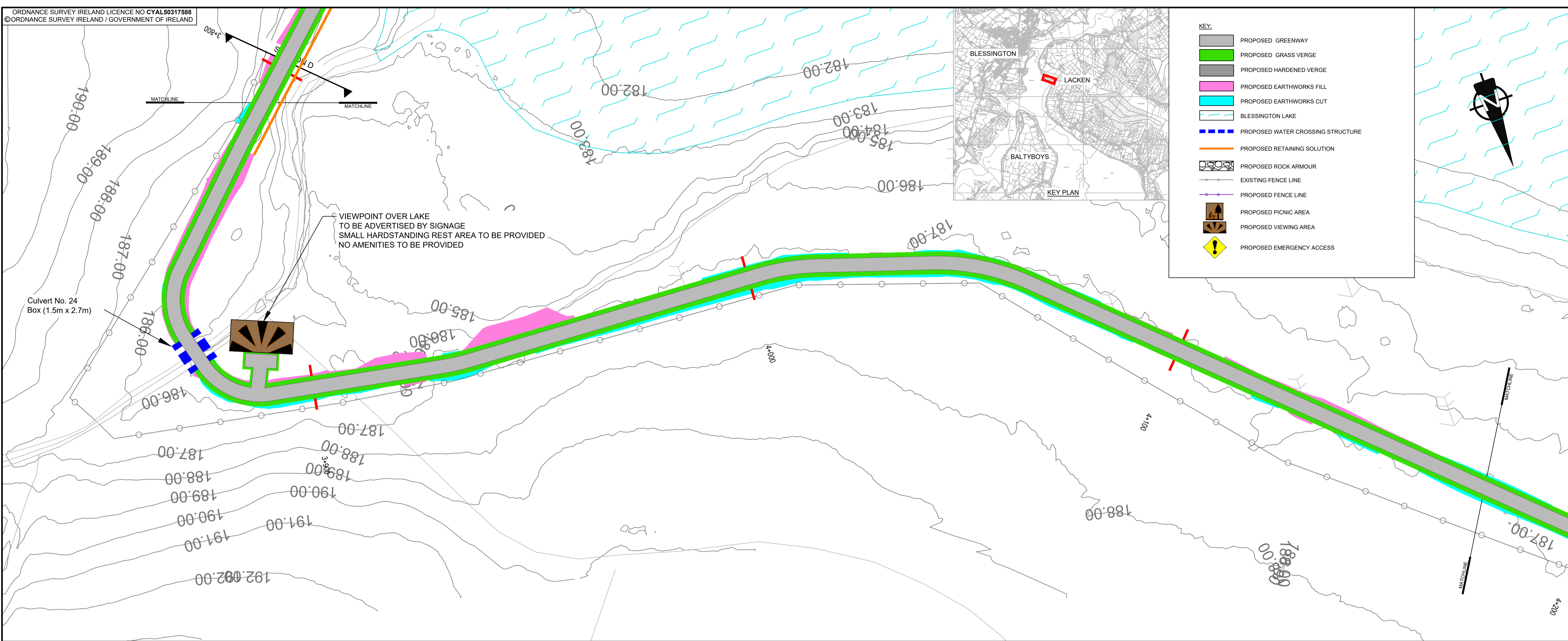

CHAINAGE	3810.000	3850.000	3900.000	3950.000	4000.000	4050.000	4100.000	4150.000	4170.000					
EXISTING LEVELS	185.809	185.901	186.351	187.011	187.337	187.202	187.078	186.799	187.101					
PROPOSED LEVELS	186.280	186.211	185.942	187.088	187.038	187.031	187.012	186.823	186.801					
VERTICAL ALIGNMENT	L=36.07 K=10.00	G=-0.36% L=28.98 K=5.00	G=-6.36% L=1.157 K=5.00	G=1.53% L=28.3	G=0.97% L=1.103.0	G=4.57% L=1.21.9	L=19.23 K=5.00	G=0.73% L=4.86 K=5.00	G=-0.25% L=1.406.4	L=2.732 K=5.00	G=0.30% L=8.26 K=5.00	G=-1.35% L=9.157 K=5.00	G=0.48% L=6.04 K=5.00	G=0.30% L=3

AECOM

PROJECT
 BLESSINGTON
 eGREENWAY

CLIENT

 WICKLOW
 ENDLESS OPPORTUNITIES

CONSULTANT
 AECOM
 DOUGLAS BUSINESS CENTRE
 CARRIGLINE ROAD
 DOUGLAS
 CORK
 Tel: +353 (0)21 436 5006
 www.aecom.com

NOTES

- THIS DRAWING IS TO BE READ IN CONJUNCTION WITH ALL OTHER RELEVANT ENGINEERING DRAWINGS. ANY DISCREPANCIES, ERRORS OR OMISSIONS TO BE BROUGHT TO THE ATTENTION OF THE EMPLOYER.
- ALL DIMENSIONS TO BE CHECKED BY THE CONTRACTOR ON SITE PRIOR TO COMMENCEMENT OF WORKS.
- EMPLOYER'S REPRESENTATIVE TO BE INFORMED BY THE CONTRACTOR OF ANY DISCREPANCIES PRIOR TO THE COMMENCEMENT OF WORKS ON SITE.
- DIMENSIONS OF ALL BOUNDARIES AND ADJOINING ROADS TO BE CHECKED ON SITE PRIOR TO COMMENCEMENT OF WORKS.
- DO NOT SCALE. ALL MEASUREMENTS AND COORDINATES TO BE CHECKED ON SITE.
- EXISTING FENCE LINES ARE INDICATIVE AND ARE TO BE CONFIRMED ON SITE. EXISTING FENCING IS TO BE REVIEWED ON SITE AND REPLACED WHERE REQUIRED.
- EMERGENCY ACCESS POINTS ARE TO BE CLOSED OFF WITH DEMOUNTABLE BOLLARDS. KEYS TO BE HANDED OVER TO THE OVERSEEING ORGANISATION.
- EGREENWAY DRAINAGE IS TO BE OVER THE EDGE DRAINAGE
- PROPOSED FENCELINE TO BE ERECTED IN ACCORDANCE WITH TII STANDARD DETAIL CC-SCD-00303.

ISSUE/REVISION

I/R	DATE	DESCRIPTION
2	DEC 2023	ABP RFI UPDATE
1	MAY 2023	ABP RFI UPDATE
0	OCT 2021	ISSUED FOR PLANNING

PROJECT NUMBER
 60617025

SHEET TITLE
 PLAN AND PROFILE
 LACKEN
 SHEET 13 OF 18

SHEET NUMBER
 60617025_SHT_DD_BLGWY_146.13

This drawing has been prepared for the use of AECOM's client. It may not be used, modified, reproduced or relied upon by third parties, except as agreed by AECOM or as required by law. AECOM accepts no responsibility, and denies any liability, whatsoever, to any party that uses or relies on this drawing without AECOM's express written consent. All measurements must be obtained from the stated dimensions.